



T-203 Tapping Machine

Sizes: 4" through 12"



T. D. Williamson, Inc.

Bulletin No: 1000.003.00

Date: June 1998

Cross Indexing No: n/a

Supersedes: 403.0 (7/1/85)



■ T203 Tapping Machine

Description

Tapping machines are used to make connections to pipelines, tanks and plant piping and are used to make hot taps in preparation for plugging machine applications.

The T-203 Tapping Machine is used for making 4" through 12" (DN 100 through DN 300) taps without shutdown in pipelines, primarily for the installation of TDW SHORTSTOPP® Plugging Machines.

Features

The T-203 Tapping Machine has an adjustable automatic feed rate of 0 to 1/8" per revolution for any cutting condition.

The T-203 Tapping Machine operates at a maximum of 740 psi (50 bar) @ 100°F (38°C). Its operating temperature is -20° F (-29° C) to 180°F (82°C) @ 675 psi (46 bar). It weighs 241 pounds (109 kg.), including the air motor drive, which is standard equipment. Lightweight with a low center of gravity, it is designed to be easy to handle and to operate.

The T-203 Tapping Machine also features a four-bolt attachment to the valve adapter. This provides a simple, rigid makeup with proper cutter alignment.

Patented in the United States and in foreign countries.
ISO 9001 Certified

Toll Free

1-888-TDWmSon (839-6766)

■ Typical Tapping Setup

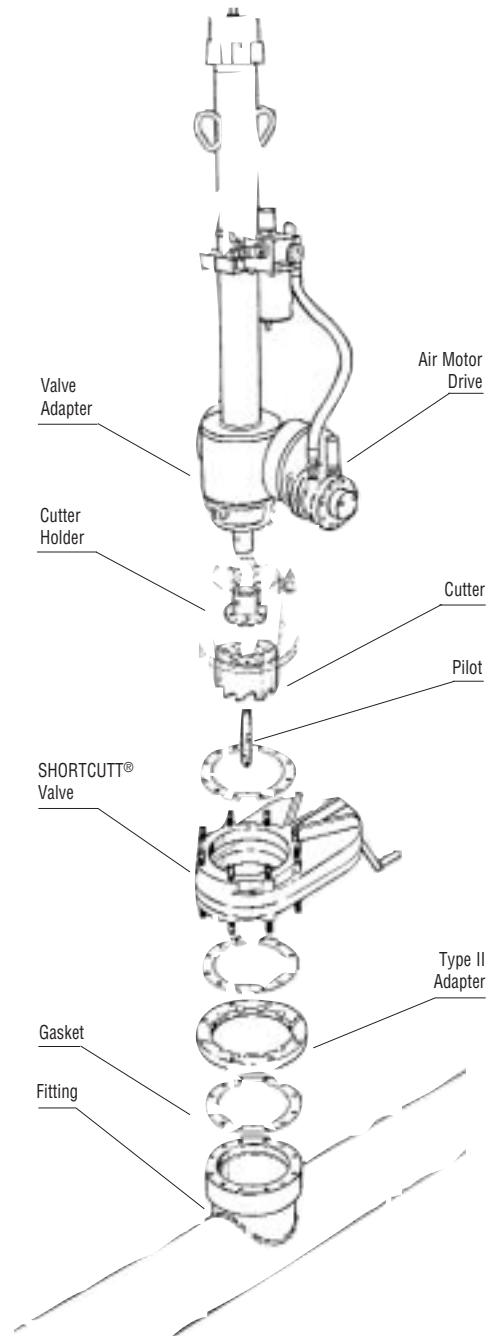



T. D. Williamson, Inc.

Dimensions and Part Numbers

T203 Tapping Machine

Basic Machine	Wt./Lbs.	Wt./Kg.	Part Number
with air drive assembly	241	109	05-2173-0000
carrying case	125	57	
	366	166	

Specifications

Boring Bar Travel		Overall Length		Rate of Travel per revolution		Feed Mechanism
Inch	mm	Inch	mm	Inch	mm	
36	914	58	1473	0-1/8	0-3	adjustable, automatic

Operating Specifications

Maximum Operating Pressure	740 psi (50 bar) @100°F (38°C)
Maximum Operating Temperature	180°F (82°C) @ 675 psi (46 bar)*

Adapters

		Max. Working Pressure				Max. Working Pressure			
		Class 150		Class 300		Class 150		Class 300	
Inch	mm	psi	Wt./Lbs.	Wt./Kg.	Part Number	psi	Wt./Lbs.	Wt./Kg.	Part Number
4	100	285	29	13	06-1542-0000	740	38	17.2	06-7370-0000
6	150	285	39	18	06-1543-0000	740	65	29.5	06-7371-0000
8	200	285	60	27	06-1544-0000	740	95	43.1	06-7372-0000
10	250	285	87	39	06-1545-0000	740	140	63.5	06-7373-0000
12	300	285	130	59	06-1546-0000	740	205	93	06-7374-0000

Cutters & Pilot Drills

		SHORTSTOPP® Cutters				SHORTSTOPP® Pilot Drills			
		Weight		Weight		Weight		Weight	
Nominal Size	Actual Size	Lbs.	Kg.	Part Number	Lbs.	Kg.	Part Number	Spare U-Rods	
4	3-7/8	3	1	05-0255-0004	8	230	05-0247-0003	00-1424-0005	
6	5-7/8	8-3/4	4	05-0330-0006	2	8	05-0293-0002	00-1424-0003	
8	7-3/4	20	9	05-0330-0008	12	340	05-0293-0003	00-1424-0003	
10	9-3/4	23	10	05-0330-0010	16	450	05-0293-0004	00-1424-0003	
12	11-3/4	40	18	05-0330-0012	16	450	05-0293-0005	00-1424-0003	

Cutter Holders, Bleeder Valve & Nipple

	Inch	mm	Wt./Lbs.	Wt./Kg.	Part Number
Cutter Drive Key	4	80	0.5	0.25	05-0227-0000
Cutter Holder	6-12	150-300	9	4	05-0326-0000
Bleeder Valve	--	--	--	--	00-0774-0001
Nipple	--	--	--	--	00-0220-0001
Spare U-Rods	4	--	--	--	00-1424-0005
Spare U-Rods	6-12	--	--	--	00-1424-0003